

圧力荷重換算表

2000kN200ストロークCH型 油圧ジャッキ

| | |
|--------|-----------------------|
| 最低機械高 | 415 mm |
| ホール径 | 90 mm |
| 受圧面積 | 302.4 cm ² |
| 最高使用圧力 | 66.1 MPa |
| 所要油量 | 6.1 L |
| 重量 | 約153 kg |

圧力 : MPa $\times 10.2$ kg/cm²

荷重 : ton $\times 9.8$ kN

圧力[MPa] \times 受圧面積[cm²]/10=荷重[kN]

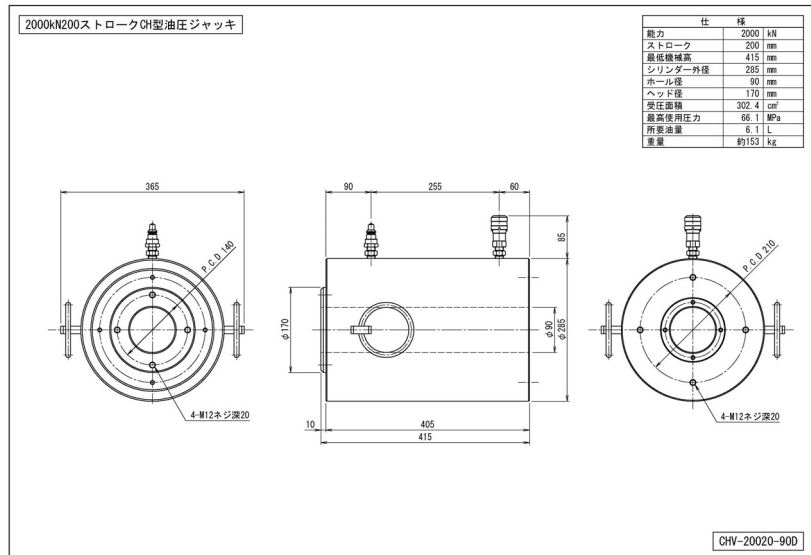

| 圧力 | | 荷重 | |
|-----|--------------------|-----|------|
| MPa | kg/cm ² | kN | ton |
| 1 | 10 | 30 | 3.1 |
| 2 | 20 | 60 | 6.2 |
| 3 | 31 | 91 | 9.3 |
| 4 | 41 | 121 | 12.3 |
| 5 | 51 | 151 | 15.4 |
| 6 | 61 | 181 | 18.5 |
| 7 | 71 | 212 | 21.6 |
| 8 | 82 | 242 | 24.7 |
| 9 | 92 | 272 | 27.8 |
| 10 | 102 | 302 | 30.8 |
| 11 | 112 | 333 | 33.9 |
| 12 | 122 | 363 | 37.0 |
| 13 | 133 | 393 | 40.1 |
| 14 | 143 | 423 | 43.2 |
| 15 | 153 | 454 | 46.3 |
| 16 | 163 | 484 | 49.4 |
| 17 | 173 | 514 | 52.4 |
| 18 | 184 | 544 | 55.5 |
| 19 | 194 | 575 | 58.6 |
| 20 | 204 | 605 | 61.7 |

| 圧力 | | 荷重 | |
|-----|--------------------|------|-------|
| MPa | kg/cm ² | kN | ton |
| 21 | 214 | 635 | 64.8 |
| 22 | 224 | 665 | 67.9 |
| 23 | 235 | 696 | 70.9 |
| 24 | 245 | 726 | 74.0 |
| 25 | 255 | 756 | 77.1 |
| 26 | 265 | 786 | 80.2 |
| 27 | 275 | 816 | 83.3 |
| 28 | 286 | 847 | 86.4 |
| 29 | 296 | 877 | 89.4 |
| 30 | 306 | 907 | 92.5 |
| 31 | 316 | 937 | 95.6 |
| 32 | 326 | 968 | 98.7 |
| 33 | 337 | 998 | 101.8 |
| 34 | 347 | 1028 | 104.9 |
| 35 | 357 | 1058 | 108.0 |
| 36 | 367 | 1089 | 111.0 |
| 37 | 377 | 1119 | 114.1 |
| 38 | 388 | 1149 | 117.2 |
| 39 | 398 | 1179 | 120.3 |
| 40 | 408 | 1210 | 123.4 |

| 圧力 | | 荷重 | |
|------|--------------------|------|-------|
| MPa | kg/cm ² | kN | ton |
| 41 | 418 | 1240 | 126.5 |
| 42 | 428 | 1270 | 129.5 |
| 43 | 439 | 1300 | 132.6 |
| 44 | 449 | 1331 | 135.7 |
| 45 | 459 | 1361 | 138.8 |
| 46 | 469 | 1391 | 141.9 |
| 47 | 479 | 1421 | 145.0 |
| 48 | 490 | 1452 | 148.1 |
| 49 | 500 | 1482 | 151.1 |
| 50 | 510 | 1512 | 154.2 |
| 51 | 520 | 1542 | 157.3 |
| 52 | 530 | 1572 | 160.4 |
| 53 | 541 | 1603 | 163.5 |
| 54 | 551 | 1633 | 166.6 |
| 55 | 561 | 1663 | 169.6 |
| 56 | 571 | 1693 | 172.7 |
| 57 | 581 | 1724 | 175.8 |
| 58 | 592 | 1754 | 178.9 |
| 59 | 602 | 1784 | 182.0 |
| 60 | 612 | 1814 | 185.1 |
| 61 | 622 | 1845 | 188.2 |
| 62 | 632 | 1875 | 191.2 |
| 63 | 643 | 1905 | 194.3 |
| 64 | 653 | 1935 | 197.4 |
| 65 | 663 | 1966 | 200.5 |
| 66 | 673 | 1996 | 203.6 |
| 66.1 | 674 | 1999 | 203.9 |